



SURVEY ROUTE DESCRIPTION FORM
 Wisconsin Frog and Toad Survey (WFTS)
 Wisconsin Department of Natural Resources



Form 1700-010
 Revised April 2022

These site descriptions (along with your maps) should be precise enough that another observer could use only these materials and conduct calling surveys from the exact same locations.

County	Dodge	Name of Observer(s) Completing this Form
Route #	142	Jane Smith
Year	2006	Joe Smith

SITE DESCRIPTIONS

Site #	Location of Listening Point (Latitude/Longitude(Decimal Degrees)/Road Names/Where to stand)	Name and Description of Wetland
1.	Lat(DD): N 43.45886 Long(DD): W -88.620646 Listen from Hwy 28 roadside, 1/4 mile north of Raaschs Hill Road/Hwy 28 intersection, just north of Horicon.	"Horicon Marsh 1 - Hwy 28" Open water on west side of road.
2.	Lat(DD): N 43.466637 Long(DD): W -88.609414 Located 1 mile northeast of Horicon, near the Hwy 28/access road intersection. Listen from access road just east of Hwy 28.	"Horicon Marsh 2 - Hwy 28" Open water on east side of road.
3.	Lat(DD): N 43.505314 Long(DD): W -88.591994 Located on unnamed road north of Bay View Road. Listen from boat landing on south side of river.	"Horicon Marsh Wildlife Area - East Branch Rock River" - small river.
4.	Lat(DD): N 43.512553 Long(DD): W -88.59134 Listen from the end of Northern Road (runs along the west side of the river).	"Horicon Marsh Wildlife Area - end of Northern Road" - small river.
5.	Lat(DD): N 43.518374 Long(DD): W -88.587068 Located on Northern Rd, 1/3 mile south of the intersection with Dike Rd at first bend in the road. Listen from the road at the edge of the marsh.	"Horicon Marsh Wildlife Area - Northern Road marsh" - large marsh.
6.	Lat(DD): N 43.523489 Long(DD): W -88.59094 Located on Dike Road, 1/2 mile west of intersection with Rockvale Rd. Listen from roadside at culvert near bend in the road.	"Horicon Marsh Wildlife Area - Dike Road" - small marsh.
7.	Lat(DD): N 43.549256 Long(DD): W -88.588297 Located on Cnty Hwy Z, 1/8 mile south of intersection with Kantin Rd. Listen from Hwy Z roadside.	"Horicon NWR Marsh" Marsh located on both sides of road.
8.	Lat(DD): N 43.597065 Long(DD): W -88.644185 Listen from end of Ledge Road, at Strooks Ditch.	"Horicon NWR - Strooks Ditch" Several small areas of open water.
9.	Lat(DD): N 43.611775 Long(DD): W -88.644133 Located on Old Marsh Rd, 1.5 miles west of Point Rd at northerly bend in road. Listen from Old Marsh Road at the Main Ditch control structure.	"Horicon NWR - Main Ditch" - small marsh.
10.	Lat(DD): N 43.63284 Long(DD): W -88.621204 Located on Hwy 49, 1/8 mile west of intersection with Stumpf Rd. Listen from Hwy 49 roadside. (Fond du Lac/Dodge County line)	"Horicon NWR - Hwy 49" - small marsh.

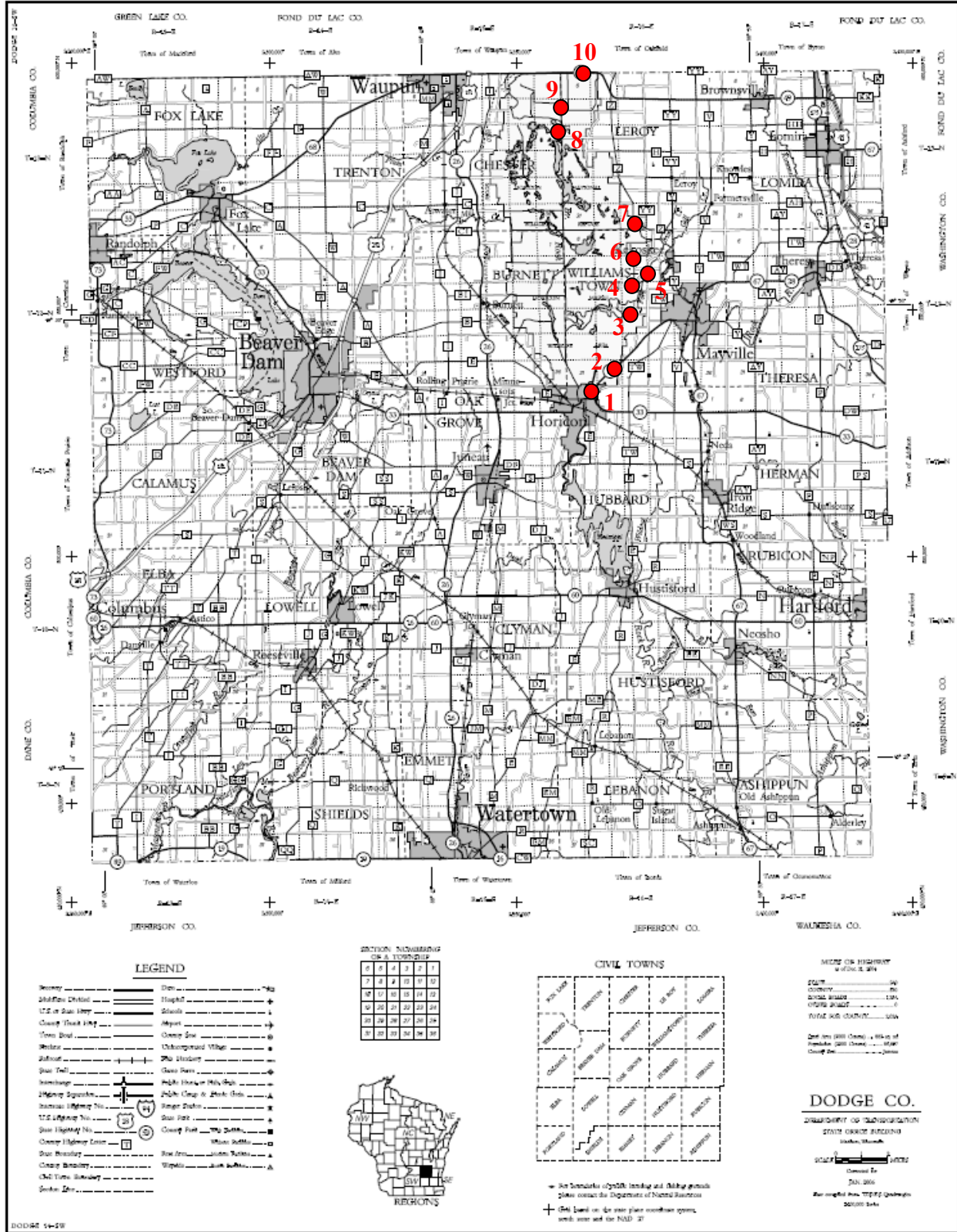

Figure 3. Sample county map used for setting up and mapping new routes.

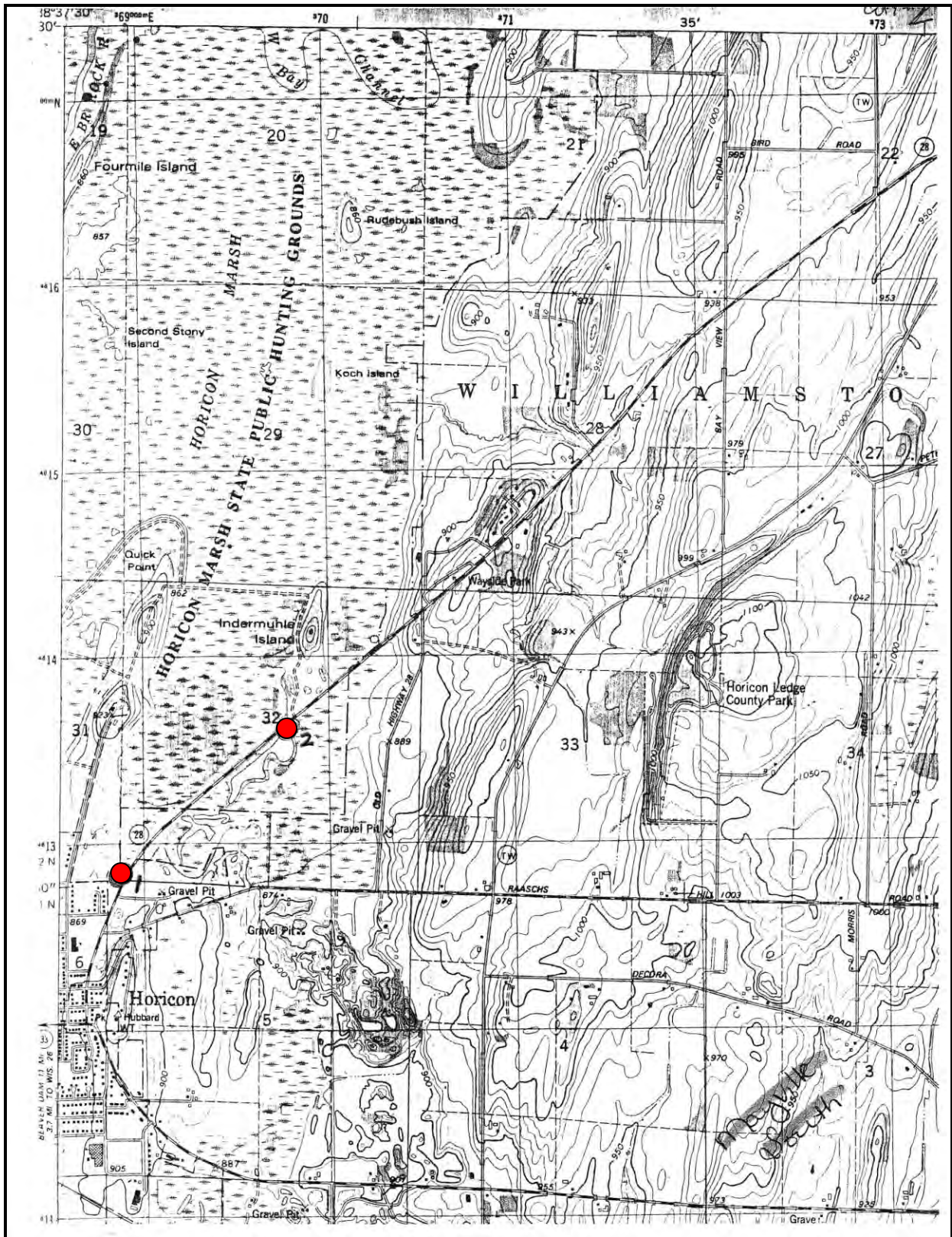

Figure 4. Sample topographic map used for setting up and mapping new routes, showing more detail than the overview county map (Figure 3).